



©TM guntû







SETOUCHI ROAMING

A small inn floating in the Seto Inland Sea—guntô is a luxury journey through Japan unlike any other.

Guntô roams across Setouchi, as people call the archipelago of small islands in western Japan woven together by the calm waters of the Seto Inland Sea. Setouchi is a beautiful and mysterious world unto itself, with more than 700 islands floating in a seascape of 23,000 square kilometers and 7,000 kilometers of shoreline.

Since ancient times, these waters have bustled with boats connecting western Japan to Osaka and Tokyo to the east, as well as foreign trading vessels. Its shores have been dotted with the hideouts of legendary Japa-

nese pirates, and the footprints of Korean delegations and foreign missionaries.

Guntô was conceived as an “inn” where travelers can pass time upon the sea while enjoying the nature and culture of Setouchi.

Relax as this space resembling a Japanese *ryokan* blends into the gentle scenery of Setouchi.

ACCOMMODATIONS

Guntû accommodates guests in 19 cabins with four suite styles. All 19 wood-paneled cabins are designed by architect Yasushi Horibe, known for his Japanese-style homes, and feature terraces placed close to the surface of the sea. As the floating hotel blends into the Setouchi seascape, the experience of being aboard is like staying at a friend's elegant guest house.

The refreshing wooden interiors form a comfortable cocoon from which to enjoy the rustic view of Setouchi. High-quality items such as soft Imabari towels and sheets have been included for your comfort.





THE guntû SUITE

(1 cabin)

The bow of the ship is exclusively reserved for The guntû Suite. This is the only cabin with forward-facing windows. While gazing ahead and to the sides at the view sliding past, you can enjoy guntû at its best in this special space.

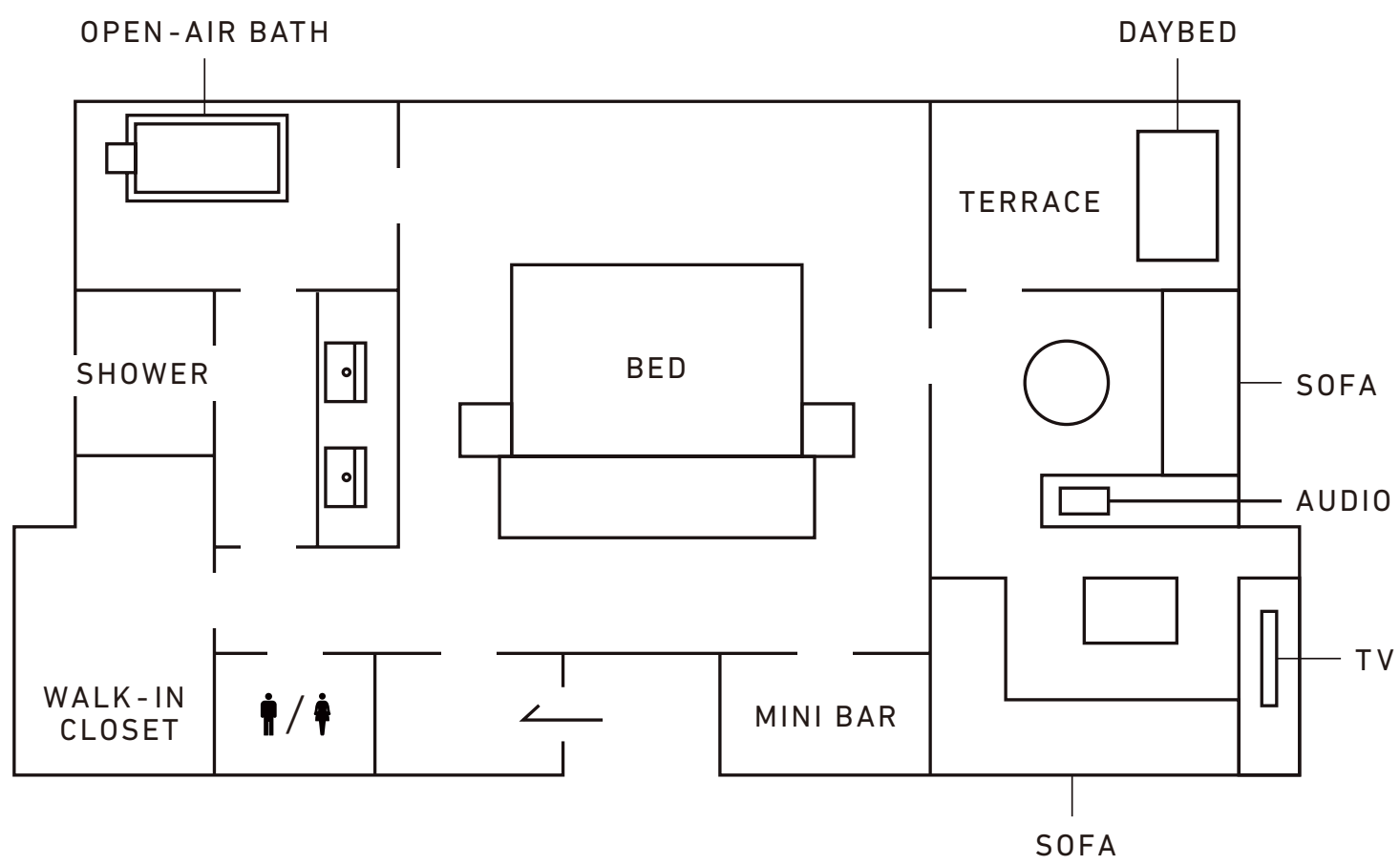

THE GUNTÛ SUITE (Approximately 90 m² / 969 ft²)

- MAIN FEATURES
- Simmons Beds (Hollywood Twin)
 - Sofa / Writing Desk
 - Terrace with Daybed
 - Open-Air Cypress Bath
 - Minibar / Wine Cellar
 - iPad
 - Bang & Olufsen Bluetooth Speaker
 - Audio Tekne Sound System
 - Television
 - Complimentary Wi-Fi

GRAND SUITE

(2 cabins)

Grand Suite has the largest terrace of the four cabin types. As you soak in the open-air bath on the spacious terrace, you can have the beautiful panorama view of Setouchi all to yourself.

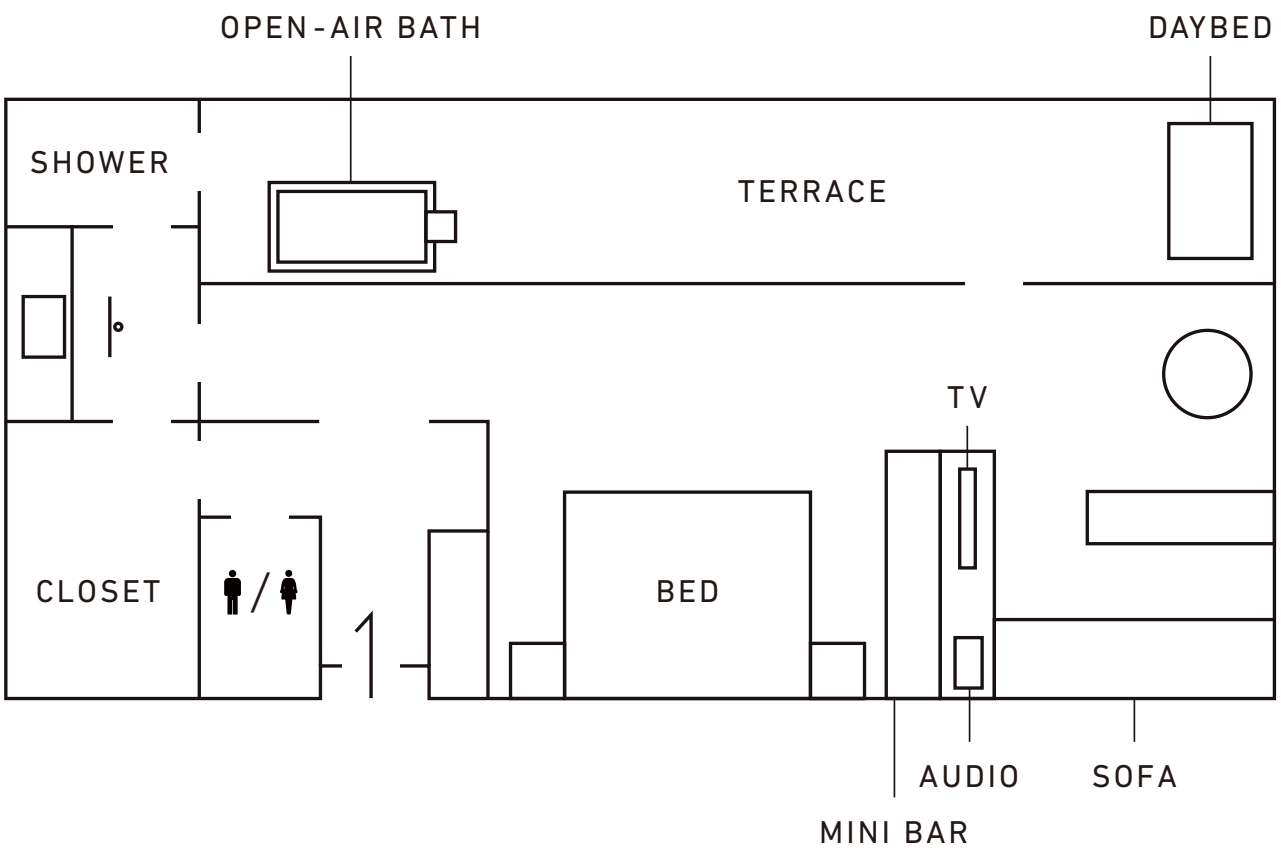

GRAND SUITE (Approximately 80 m² / 862 ft²)

- MAIN FEATURES
- Simmons Beds (Hollywood Twin)
 - Sofa / Writing Desk
 - Terrace with Daybed
 - Open-Air Cypress Bath
 - Minibar / Wine Cellar
 - iPad
 - Bang & Olufsen Bluetooth Speaker
 - Audio Tekne Sound System
 - Television
 - Complimentary Wi-Fi



TERRACE SUITE

With Open-Air Bath (2 cabins)

—

The bed is closest to the window in this cabin, giving you an unobstructed, intimate view toward the horizon. An open-air bath allows you to relax outdoors while still in the comfort of your own suite.

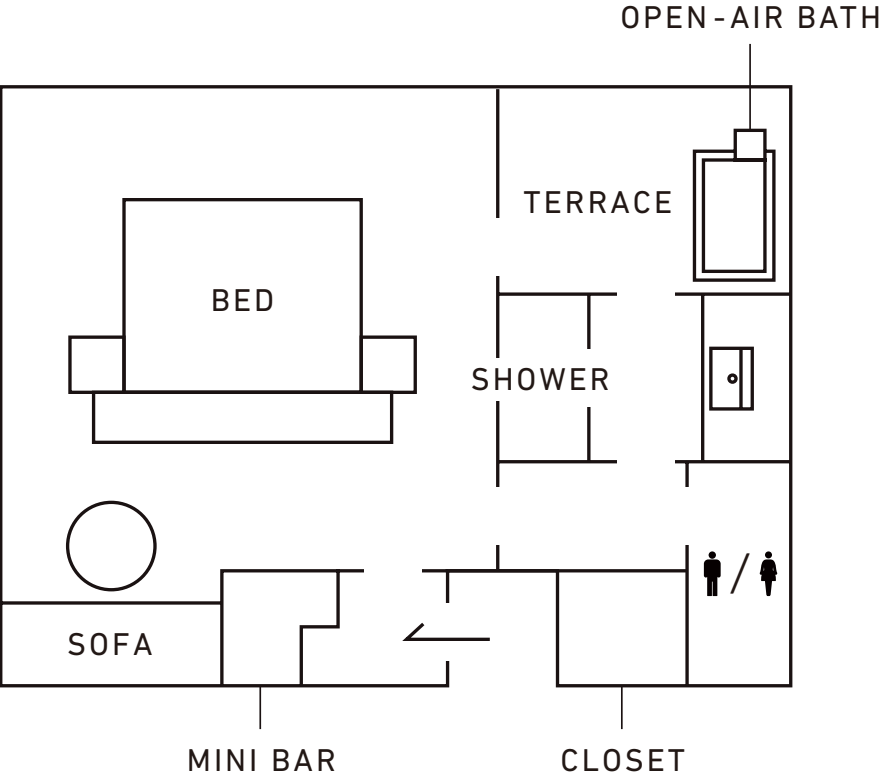

TERRACE SUITE WITH OPEN-AIR BATH (Approximately 50 m² / 538 ft²)

- MAIN FEATURES
- Simmons Beds (Hollywood Twin)
 - Sofa / Writing Desk
 - Terrace
 - Open-Air Cypress Bath
 - Minibar / Wine Cellar
 - iPad
 - Bang & Olufsen Bluetooth Speaker
 - Complimentary Wi-Fi



TERRACE SUITE

(14 cabins)

This cabin's seaside sitting area lets you perch at the edge of the water. The glassed-in bathroom located along the terrace makes for an enjoyable bathing experience regardless of the weather, while giving you a sense of being one with the sea.

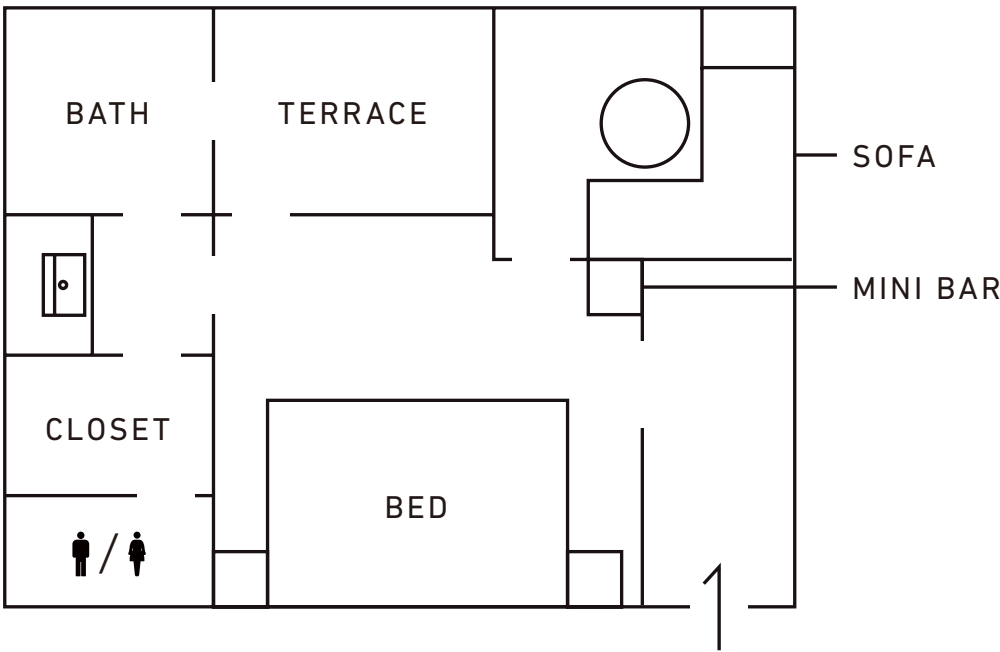

TERRACE SUITE (Approximately 50 m² / 538 ft²)

MAIN FEATURES

- Simmons Beds (Hollywood Twin)
- Sofa / Writing Desk
- Terrace
- Bath
- Minibar / Wine Cellar
- iPad
- Bang & Olufsen Bluetooth Speaker
- Complimentary Wi-Fi



DINING

Enjoy what you want, as much as you want. This is the essential concept of guntû hospitality.

In the dining area, we make use of ingredients from different areas around eastern and western Setouchi, depending on the weather and mood of the day. You will discover exquisite ingredients that our chefs prepare to meet your preferences.

The best ingredients for every type of dish. Simplicity and refinement are the cornerstones of our cuisine.

Take pleasure in the luxury of exceptional dining as you float across the sea.



JAPANESE CUISINE

Dining Room



Our Japanese cuisine inherits the teachings of Kenzo Sato of Shigeyoshi, an acclaimed restaurant in Tokyo. Select your favorite ingredients from a selection of fresh fish and meat from the Setouchi region, and it will be cooked as you wish — anything from *sashimi* to broiled fish. The head chef will present his special of the day for your selection.





SUSHI

Sushi Bar



Supervised by Nobuo Sakamoto, the cozy six-seat sushi bar features a view of the ever-changing scenery outside.

Delight in the delicate yet profound flavor of the local fish served with citrus, and savor subtle differences resulting from the location and season of the catch.





JAPANESE STYLE WESTERN CUISINE

Dining Room



Guntû's Western cuisine is based on the nostalgic Japanese style of Western dishes known as *yoshoku*, prepared simply but with great care. Enjoy guntû's original dishes such as seafood croquettes and stew made from Setouchi ingredients. You may order small portions from this menu along with Japanese cuisine.





COFFEE & DRINKS

Café& Bar / Lounge



At the Café & Bar, you can enjoy original cocktails inspired by the essence of various islands as you soak in the scenery ahead on the open deck under guntû's unique gabled roof. At the lounge located in the stern, you can spend quiet time reading books from the library while enjoying a drink of your choice.



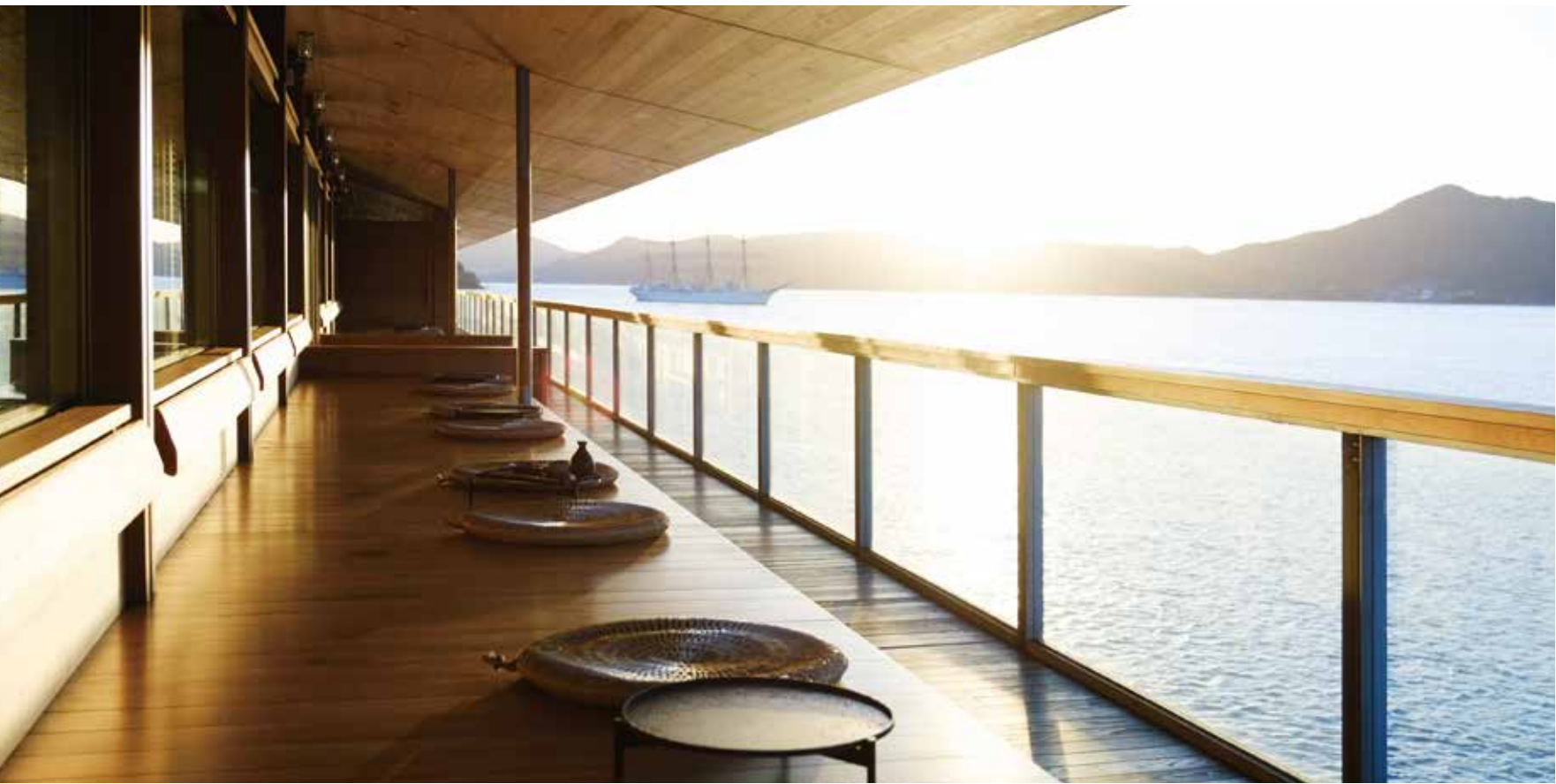

JAPANESE STYLE VERANDA

The Engawa

—

The Engawa is a traditional Japanese style of veranda found in temples and houses. From olden times, Japanese people have cherished moments on the Engawa, lost in thought while sipping tea and gazing at rock gardens. Dressed in *yukata* with your favorite snacks and sake by your side, you can savor the slow flow of time in Japan.





EXPERIENCE OF TEA CEREMONY AT THE LOUNGE

Lounge



The tea master serves you *matcha* green tea and Japanese sweets at a table with chairs. The sweets are supervised by Joichiro Kita from Nara's Kashiya, and use ingredients carefully grown from scratch. These sweets are prepared in front of you in the traditional manner, an unusual style of presentation in this day and age.





RELAXATION & FITNESS

The spa area includes treatment rooms, communal baths, saunas and a gym. For relaxation, original treatment and massage menus have been prepared to meet the mood and physical condition of each and every individual. Choukoku-Lymph® Treatments are a slow and deep method of care performed while warming your body on a natural stone mat. From a facial to the entire body, total care is available.

Japanese-style Nentai massage eases your body's distortions and tension, and nurtures a healthy state with an approach tailored to your needs. These appointment-only beauty and bodywork sessions are normally available in the treatment rooms. In addition, bodywork procedures are also available in The guntû Suite, Grand Suites and Terrace Suites.



EXPLORATIONS

Going ashore on islands along the ship's route using our dedicated speed boats, you have a chance to visit places not normally available for sightseeing. Enjoy morning strolls along quiet lanes among the remains of old houses, observe seasonal activities such as cherry blossom and autumn leaves, or the chance to watch local festivals that only take place once a year. Gain first-hand knowledge of local ways of life and culture.

ROUTES

After departing from the home port of Bella Vista Marina in Hiroshima's Onomichi City, without docking at any ports, guntû roams Setouchi and anchors beside an island's silhouette at night. We offer more than 6 routes through eastern, western, and central Setouchi.

WESTWARD ROUTE

Stretching from the islands of the Shimanami Kaido and Tobishima Kaido westward to the Kutsuna Islands and Kaminoseki, these routes travel through waters rich with the romance of history, home to Miyajima’s Itsukushima Shrine and Omishima’s Oyamazumi Shrine. The routes navigate between islands separated by narrow “Seto” straits, letting you glimpse the scenery of everyday life in Setouchi up close.

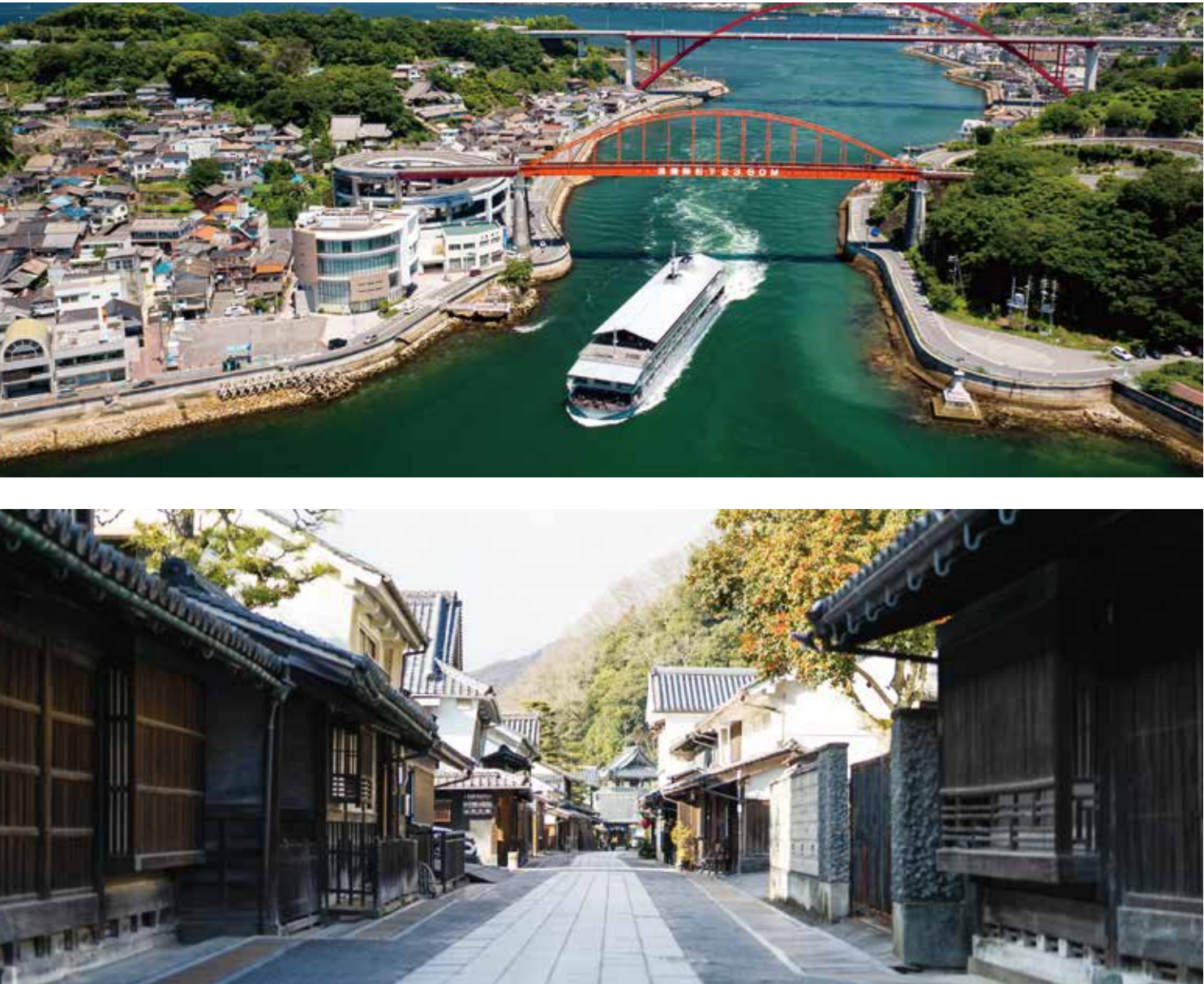

CENTRAL ROUTE

These routes cruise through the waterways of the Shimanami Kaido, a chain of six islands linked by seven bridges, and the Tobishima Kaido, a series of seven islands linked on the west end to Kure. The central routes have features of both the eastern and western routes, condensing the delicate and bold, still and dynamic allure of Setouchi.



EASTWARD ROUTE

Passing through the Kasaoka Islands and traveling beneath the Great Seto Bridge, these routes explore a region of islands rich with distinctive industrial culture, from the art islands of Inujima and Teshima to Shodoshima. The waters of the eastern Inland Sea are more open than the west, offering impressive views of dynamic structures like the Great Seto Bridge and wide vistas of islands and towns in the distance.



SHIP NAME : gunt^u

—

The ship's name “gunt^u” is borrowed from the nickname of a blue crab native to Setouchi. In that spirit, the ship features the rich delicacies of Setouchi and passes down its traditions and culture. It is our hope that it will be loved forever by passengers as well as locals. The circumflex above the ‘u’ (^u) evokes the ship's hull and the symbolic form of the gabled roof.



BASIC SPECIFICATIONS

- Gross Tonnage : 3,013 tons
- Length : 81.2 meters
- Width : 13.75 meters
- Main Engine : 2 water cooled three-phase induction motors
- Cruising Speed : 10 knots
- Passenger Capacity : 38 (Guest Number)

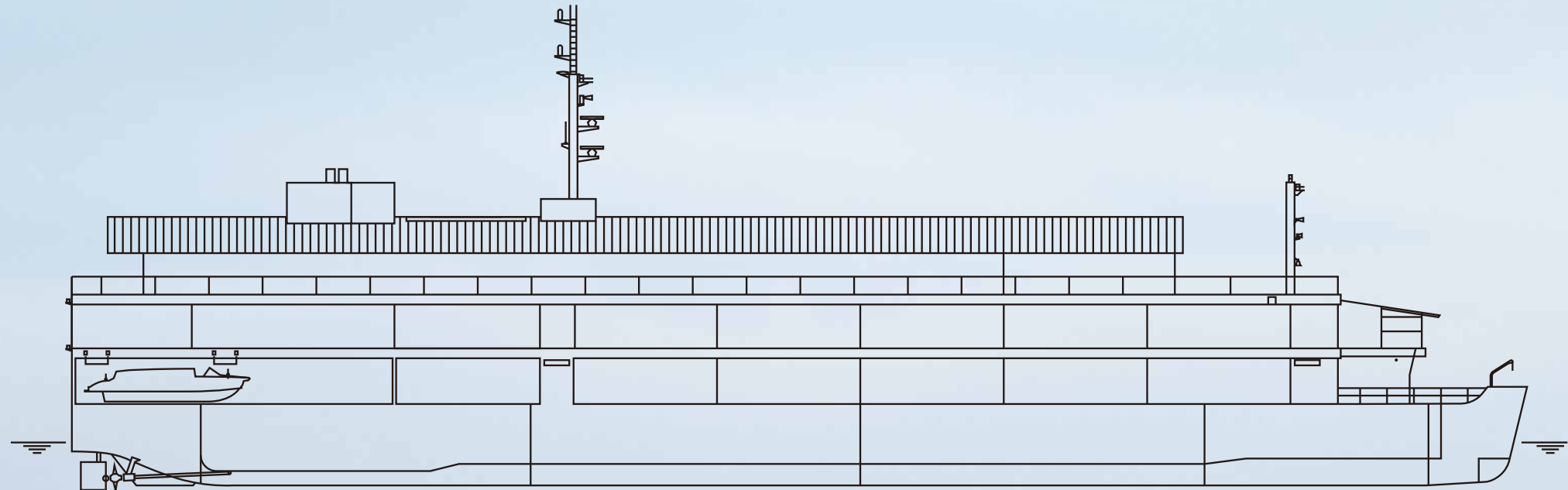

DECK 3

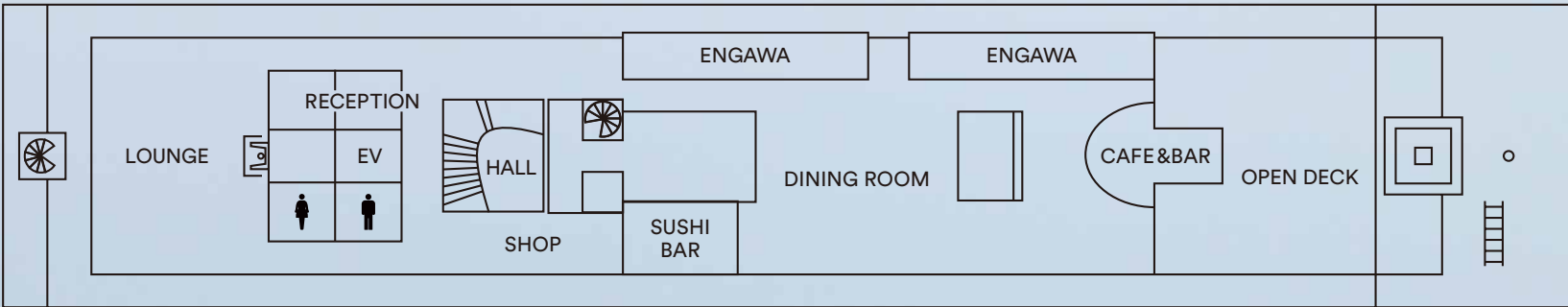

DECK 2

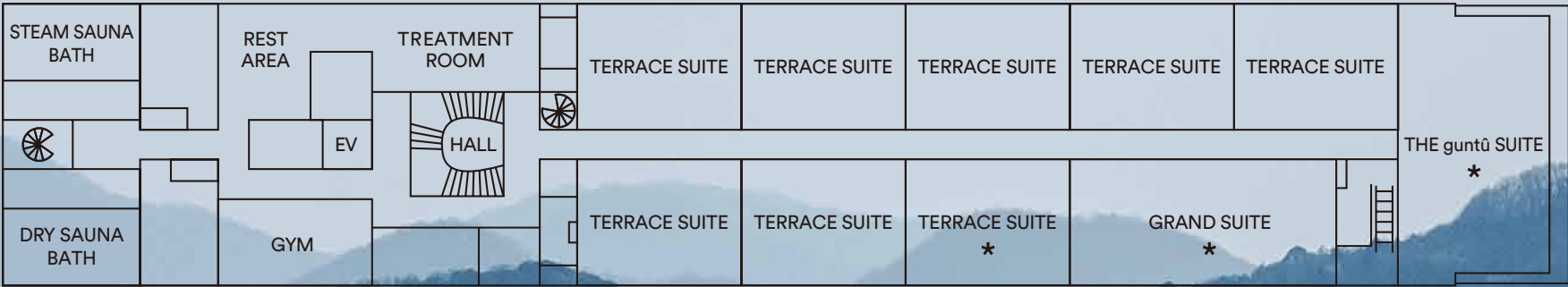

DECK 1

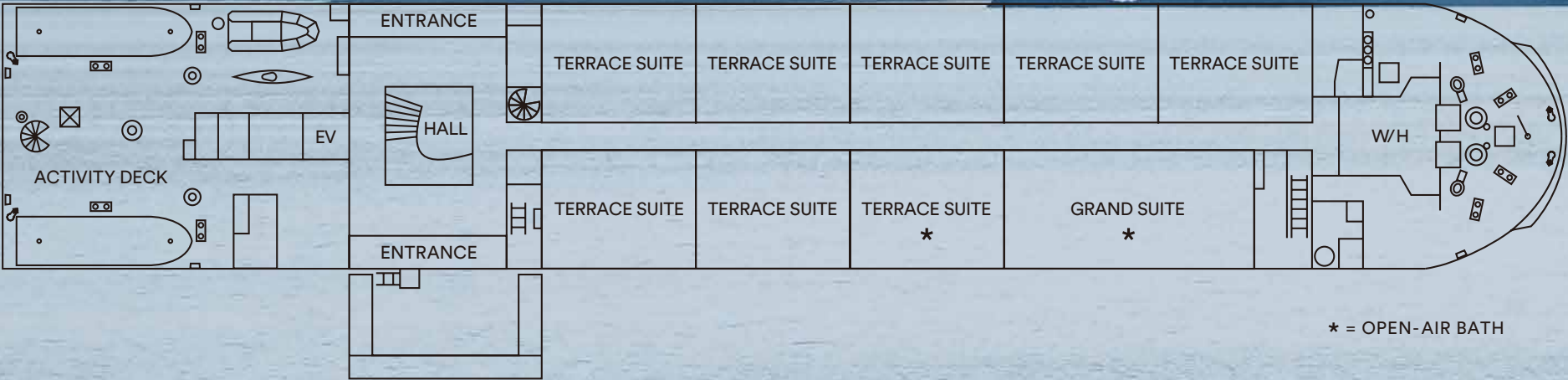

LOCATION

Bella Vista Marina
1364-6 Urasaki-cho, Onomichi, Hiroshima

INQUIRY

Tel: +81-3-6823-6055
Email: info-en@guntu.jp

ACCESS

By Shinkansen (Bullet Train)

TOKYO – FUKUYAMA / 3.5 hours

SHIN OSAKA – FUKUYAMA / 1 hour

From Fukuyama Station by car approx. 40 minutes

By Air

HANEDA AIRPORT – HIROSHIMA / 1.5 hours

From Hiroshima Airport by car approx. 1 hour

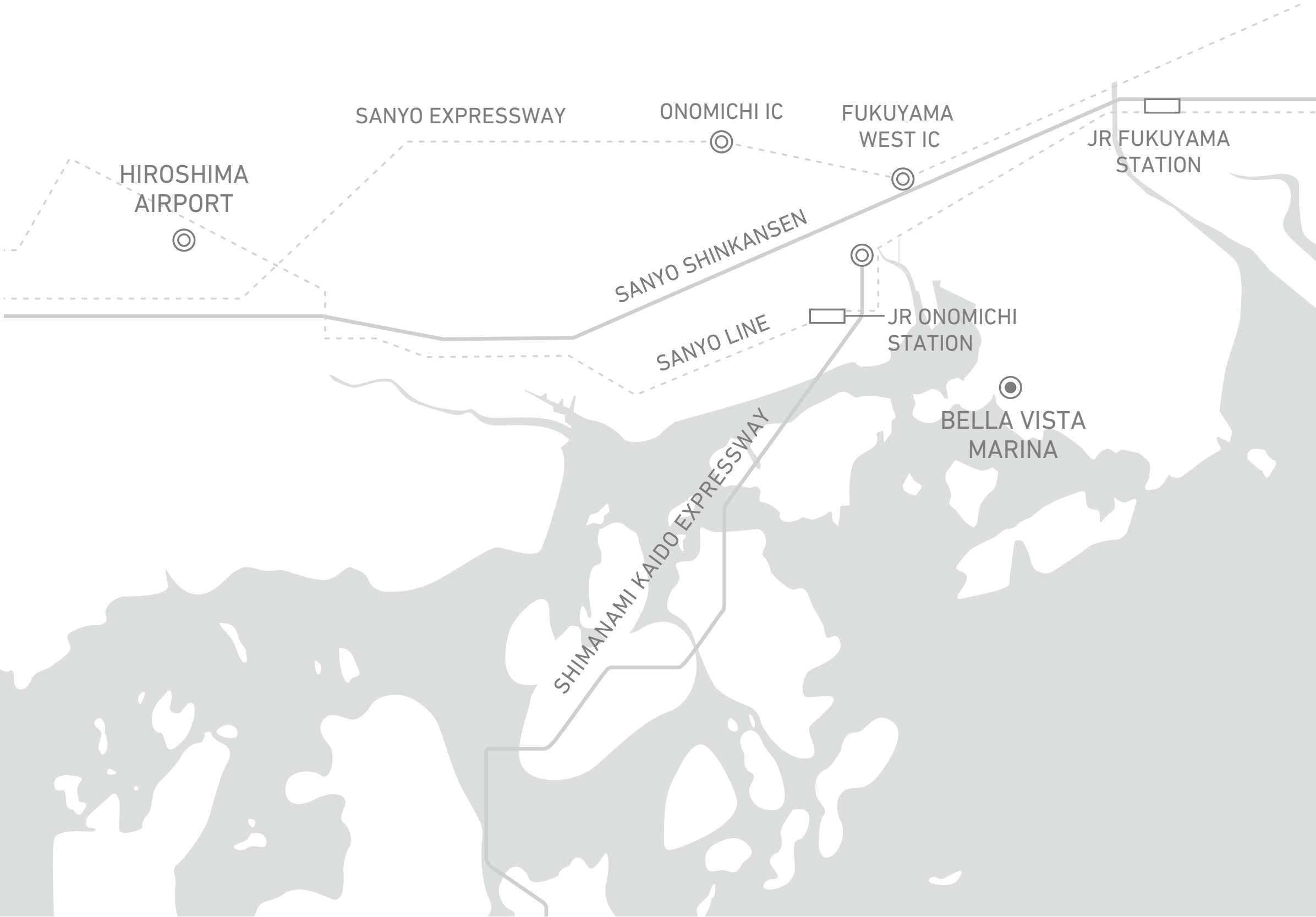
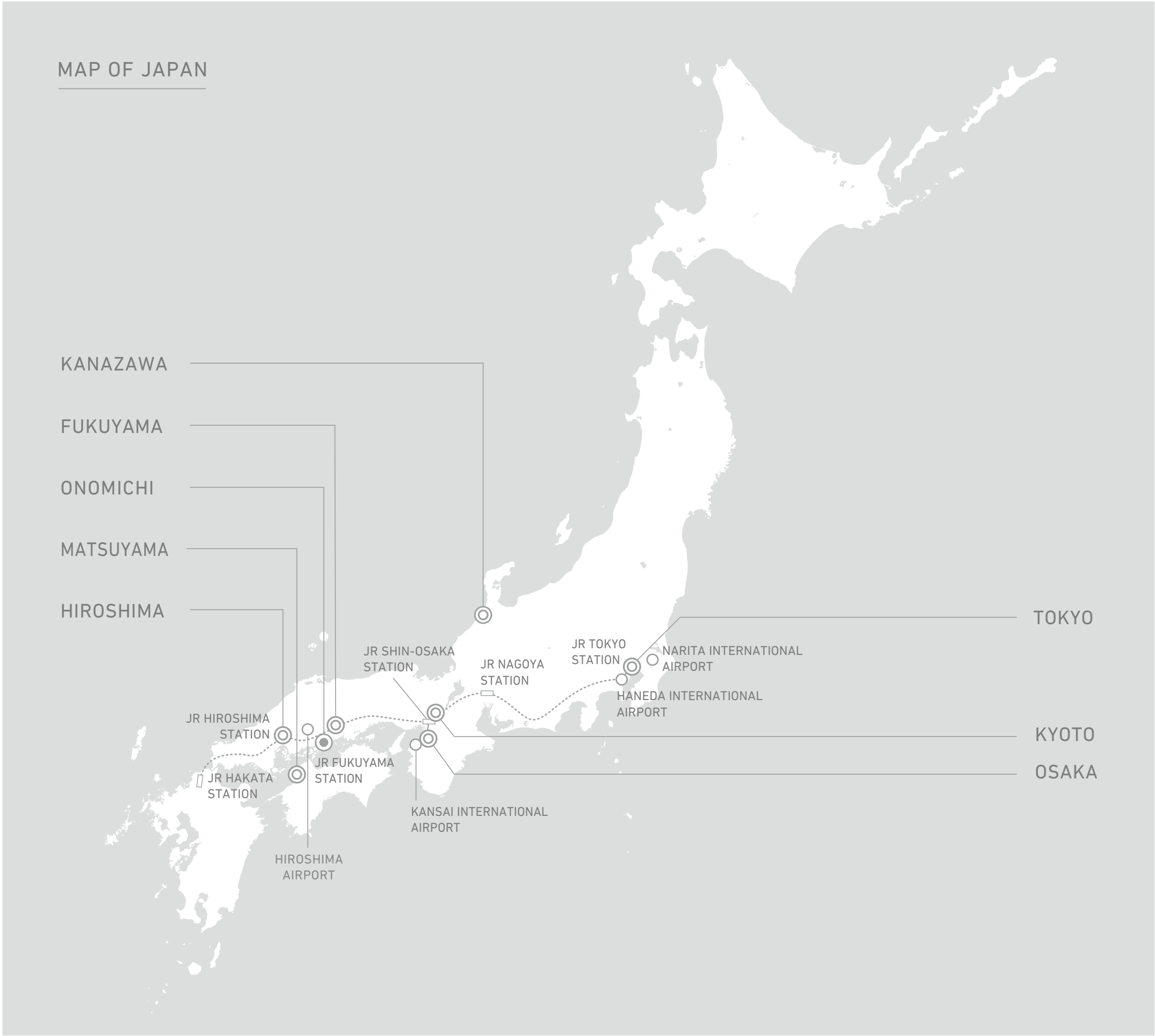



guntu.jp

